

Imperial Valley Campus

Administration

Dean: Stephen B. W. Roeder
Associate Dean for Academic Affairs: Stephen A. McNett
Interim Assistant Dean for Student Affairs: Miguel Rahiotis
Director of Financial and Business Services: Irma Martinez
Director of Advancement: John Renison

Faculty

Emeritus: Ayala, Baldwin, Ballesteros, Fatemi, Harmon, Hill, King, Merino, Polich, Spencer, Varela-Ibarra
Professors: Dunn, Elizondo, Medeiros, Neumann, Reyes, Roeder, Ryan, Shumaker
Associate Professors: Amaral, Castañeda, Champion, Coates, Garrison, Sabbath, Stampfl
Assistant Professors: Herrera, Itzá, King, Mendez, Perner, Ponce, Ramirez-Pimienta, Verzi, West
Lecturers: Cook, Fuentes, Livingston, McNett, Murphy

General Information

The Imperial Valley Campus is a branch campus of San Diego State University serving the desert area of southeastern California. It is accredited as an integral division of SDSU and operates under the same academic calendar. Established in 1959 by an act of the State legislature, the campus has two locations in the Imperial Valley: Calexico and Brawley. Offering the last two years of undergraduate education, graduate programs, and fifth year credential programs for teacher preparation, the campus accepts students who have at least 56 transferable units from community colleges or other accredited institutions. The Imperial Valley Campus offers students the advantages of smaller classes and individual contact with the faculty. The Imperial Valley Campus faculty are multinational in their classroom orientation and background. Interactive television provides students in Calexico the opportunity to participate in various classes broadcast live from the campus in San Diego. The Imperial Valley Campus schedules its classes to meet once a week in three-hour blocks so that students who work full time can earn 9-12 units a semester by attending classes once or twice a week. Occasional classes are also offered on the weekends.

The Imperial Valley Campus is located in Imperial County which has a population of approximately 140,000 people. Calexico is 120 miles east of San Diego, 60 miles west of Yuma, Arizona and 120 miles south of Palm Springs. Interstate 8 and State Highways 111 and 86 connect the County to the rest of the country and state. In 2003-2004, we proudly expanded our campus to two sites in order to better serve our students and our community. The Calexico location, six blocks from the Mexican border, provides the opportunity for involvement in a bicultural environment. Just across the border is Mexicali, a city of more than one million people. The Brawley location is 24 miles north of the Calexico site. It is surrounded by rich agricultural fields, the largest industry in the Imperial Valley.

The over 900 students at Imperial Valley Campus have the opportunity to be involved in a rich campus life. Student clubs, student government, lectures, art exhibits, quad musical events, library and computer center special programs enhance the students' education at SDSU – Imperial Valley Campus.

The Imperial Valley Campus Web site is <http://www.ivcampus.sdsu.edu>. The telephone number is 760-768-5500.

Curricula Offered

Undergraduate Degrees

Major in business administration (agribusiness emphasis) with the B.S. degree in applied arts and sciences.
Major in criminal justice administration with the B.S. degree in applied arts and sciences.
Major in English with the B.A. degree in liberal arts and sciences.
Major in history with the B.A. degree in liberal arts and sciences.
Major in international business (Latin America and North America emphases), with the B.A. degree in liberal arts and sciences.
Major in Latin American studies with the B.A. degree in liberal arts and sciences.
Major in liberal studies with the B.A. degree in liberal arts and sciences.
Major in mathematics with the B.A. degree in liberal arts and sciences.
Major in psychology with the B.A. degree in liberal arts and sciences.
Major in public administration with the B.A. degree in applied arts and sciences.
Major in social science with the B.A. degree in liberal arts and sciences.
Major in Spanish with the B.A. degree in liberal arts and sciences.
Minor in English.
Minor in history.
Minor in linguistics.
Minor in mathematics.
Minor in political science.
Minor in psychology.
Minor in public administration.
Minor in small business management.
Minor in Spanish.

Graduate Degrees

Master of Arts degree in Education
Concentration in Educational Leadership
Concentration in Elementary Curriculum and Instruction
Concentration in Secondary Curriculum and Instruction
In addition, the Imperial Valley Campus, in cooperation with academic units and the Graduate Division on the San Diego campus, offers the following graduate programs leading to advanced degrees.
Master of Public Administration
Master of Science degree in Business Administration
Concentration in International Business

Certificate Programs

Business Administration, Court Interpreting, Introductory Mathematics, Public Administration, Single Subject Mathematics, Translation Studies

Teaching Credentials

Basic: Multiple Subject Cross-Cultural Language and Academic Development (CLAD) emphasis, Multiple Subject Bilingual Cross-Cultural Language and Academic Development (BCLAD) emphasis: Spanish, Single Subject
Specialist: Administrative Services
Special Education
(Both in conjunction with the College of Education)
For further information on any of these degrees, see the SDSU – Imperial Valley Campus Bulletin.

Exchange Programs and Study Abroad

Graduate and undergraduate students at the SDSU-Imperial Valley Campus can enhance their education and cultural awareness by taking part in several of the many opportunities available to study abroad. The campus has active exchange agreements with universities in Argentina, Brazil, Croatia, Ecuador, Finland, France, Germany, Iran, Mexico, Morocco, Paraguay, Turkey, Ukraine, and the United Kingdom. Several other agreements are in process of negotiation with different academic institutions around the world, including Chile, Costa Rica, and Uruguay.

There are exchange programs for undergraduate students between the Imperial Valley Campus, the Universidad Autónoma de Baja California, and Centro de Enseñanza Técnica y Superior, that allow students to take classes at either of the participating universities and receive credit at their home institution.

In addition to IVC's own International programs, students may participate in any international programs at SDSU, including the California State University International Programs; the SDSU spring semester programs; or the International Student Exchange Program (ISEP) Consortia.

Research Center

California Center for Border and Regional Economic Studies (CCBRES)

The California Center for Border and Regional Economic Studies (CCBRES) specializes in research on the Imperial Valley and U.S.-Mexican border region. The center collects and compiles statistics on economic, demographic, social, environmental, and trade indicators on the Imperial County, Mexicali and the binational region and publishes a monthly bulletin of in-house and sponsored analyses of the issues in the region. CCBRES also hosts conferences and workshops on border issues, ranging from trade and economics to environmental and educational issues. The center's vision is to create a resource for the Imperial Valley, California-Baja California, Mexico border residents, and individuals interested in issues surrounding the U.S. Mexican border.

As related to the economic situation in the Imperial Valley, CCBRES has, and is, maintaining a current economic profile of the Imperial Valley. The data includes economic indicators such as demographic information, quality of life, environmental, labor and agricultural statistics, and macro economic indicators. The center is providing the community with tools to plan for the future of this binational region.

The Imperial Valley Campus has been designated by the U.S. Department of Agriculture as one of eight national centers of excellence in the United States.

Facilities

The Calexico campus is located on an eight-acre city block in the heart of Calexico's civic center along the Mexican border. The campus facilities create a pleasing architectural harmony of old and new structures surrounding a spacious central lawn area, the Rollie Carrillo Quad. Adjoining the quad, the expanded library, Rodney Auditorium, and John Stepling Art Gallery provide academic and cultural resources for the entire community. Other buildings include classroom buildings, the administration building, faculty offices, a computer lab, a bookstore, and the Student Union. In 2003-2004, we proudly expanded our campus to two sites in order to better serve our students and our community. The Brawley location is 24 miles north of the Calexico site. It is surrounded by rich agricultural fields, the largest industry in the Imperial Valley, and it houses five classrooms and one computer classroom.

The library, located at the Calexico site, is designed to facilitate research and to provide a pleasant atmosphere for study. The collection is expanding and has more than 110,000 volumes, periodicals, and newspapers which support the curricula offered on the Imperial Valley Campus. Services provided include reference assistance, CD ROM

databases, personal computers for word processing, full text database, Internet access, interlibrary loans, and photocopying facilities.

Computer assistance is available in the computer lab. Both Macintosh and IBM compatible systems and Internet access are also available on campus.

Transfer Center

The Transfer Center is a project that provides support services to identified and potential transfer students from accredited institutions. Information is provided by a professional counselor about programs and services available at San Diego State University, Imperial Valley Campus. The project works with all students but has as its goal to increase the number of underrepresented students in higher education. Underrepresented students are minorities, disabled, low income, and others not appropriately represented among the transfer population. For more information, call 760-768-5506 or visit the office located in Student Affairs.

Admission and Registration

To apply for admission to the Imperial Valley Campus, students must file a complete application and transcripts as outlined elsewhere in this catalog. Both completed application forms and transcripts should be sent to the Admissions Office, San Diego State University, Imperial Valley Campus, 720 Heber Avenue, Calexico, California 92231. Please telephone 760-768-5667 for further information. Students can register on the Internet using Webline, but only after fees are paid. Late registration is allowed during the first two weeks of the semester. Students wishing to late register must pay registration fees plus a \$25.00 late fee.

Imperial Valley Campus Scholarships

The Imperial Valley Campus students were awarded over \$41,034 in scholarships for the 2003-2004 academic year. Information and applications for scholarships are available from the Financial Aid Office. Following is a list of scholarships established at Imperial Valley Campus:

American Association of University Woman
Bertha Rosas Soroptimist International of Calexico
Calexico Educational Foundation
Calexico Unified School District Title VII Project Reap
California Correctional Peace Officer
California Eastern Star Fund
El Centro Rotary
General Dynamics Land Systems of Imperial Valley
HACU
Lilly Endowment Inc./Hispanic Scholarship Fund
Mr. and Mrs. Bernard Lipinsky
National Hispanic
Joe Patino Family
PEO Sisterhood Chapter BS
Rotary International District #5340
Scholarship Aid Association for Lutherans, The Adult Degree Completion
SDSU-IV International Programs
Tzu-Chi Foundation

Endowments:

Anheuser-Busch Companies, Inc.
William and Susan Brandt
Enrique (Kiki) Camarena
Francis and Edna Rae Frye
Jack Hart Family
Good Sport Howie
Herschel Hudson
Nancy A. Marlin
Sally McMahon/Doves

Alejandro and Florencia Nogales
 Douglas and Barbara Patiño
 Joe Patiño Family
 Jerry Pennington Memorial
 Ralph and Eva Pesqueira
 Joe and Dorothy Rodney
 Rotary International District 5340
 Ethan A. Singer
 Stephen and Susan Weber
 Title V

Commencement

The Imperial Valley Campus holds its own commencement exercises each spring, in the Rollie Carrillo Quad, prior to commencement exercises on the San Diego campus.

Imperial Valley Campus – Calexico Campus Map

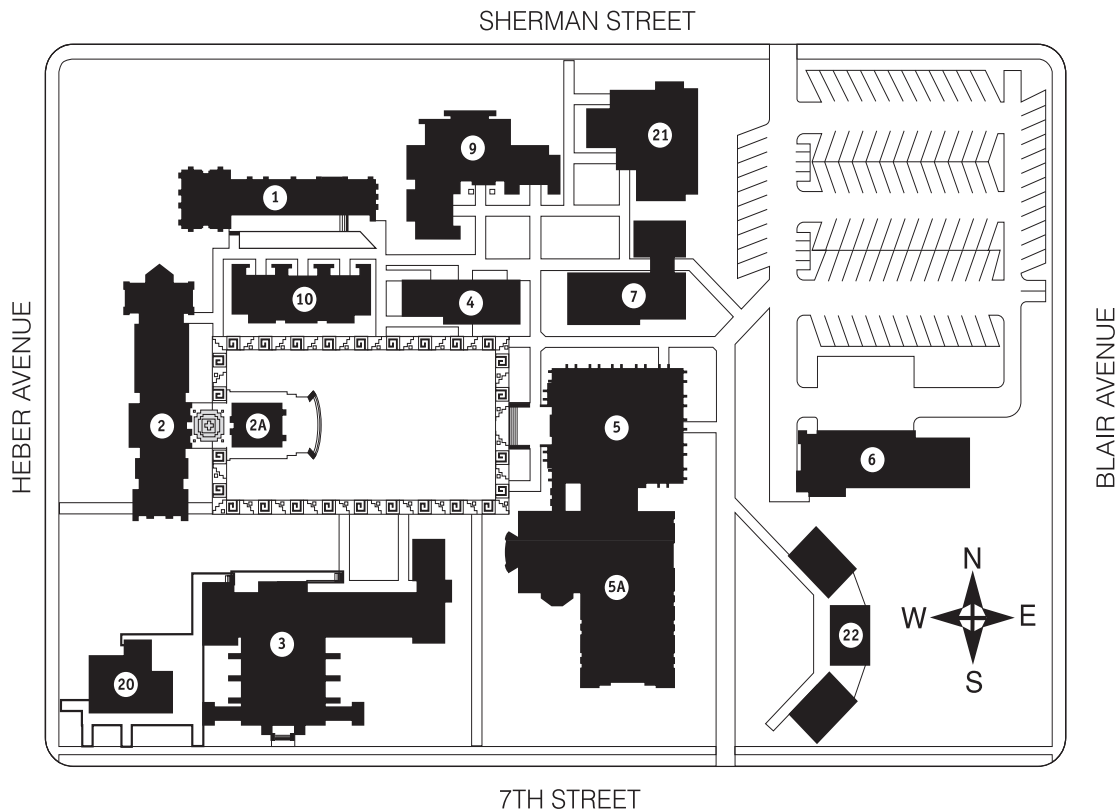

SDSU IVC Campus – Calexico
720 Heber Avenue
Calexico, CA 92231
760-768-5500

BUILDING LEGEND

- | | | |
|--|--|--|
| <ul style="list-style-type: none"> 1. North Classroom Building (N-101, N-102, N-106, N-108) 2. Administration Building (Administration/Academic Affairs/Business Office) 2A. Art Gallery 3. Auditorium/ Classrooms (A-3, LA-1, LA-2, LA-3, LA-4) | <ul style="list-style-type: none"> 4. Classroom Building (C-7, C-8, C-9, C-10) 5. Library 5A. Library Addition 6. Physical Plant 7. Computer Building 9. Faculty Offices: Building East (Classrooms) | <ul style="list-style-type: none"> 10. Faculty Offices: Building West 20. Student Center 21. Student Affairs 22. CLAT - Classrooms |
|--|--|--|

Imperial Valley Campus – Brawley Campus Map

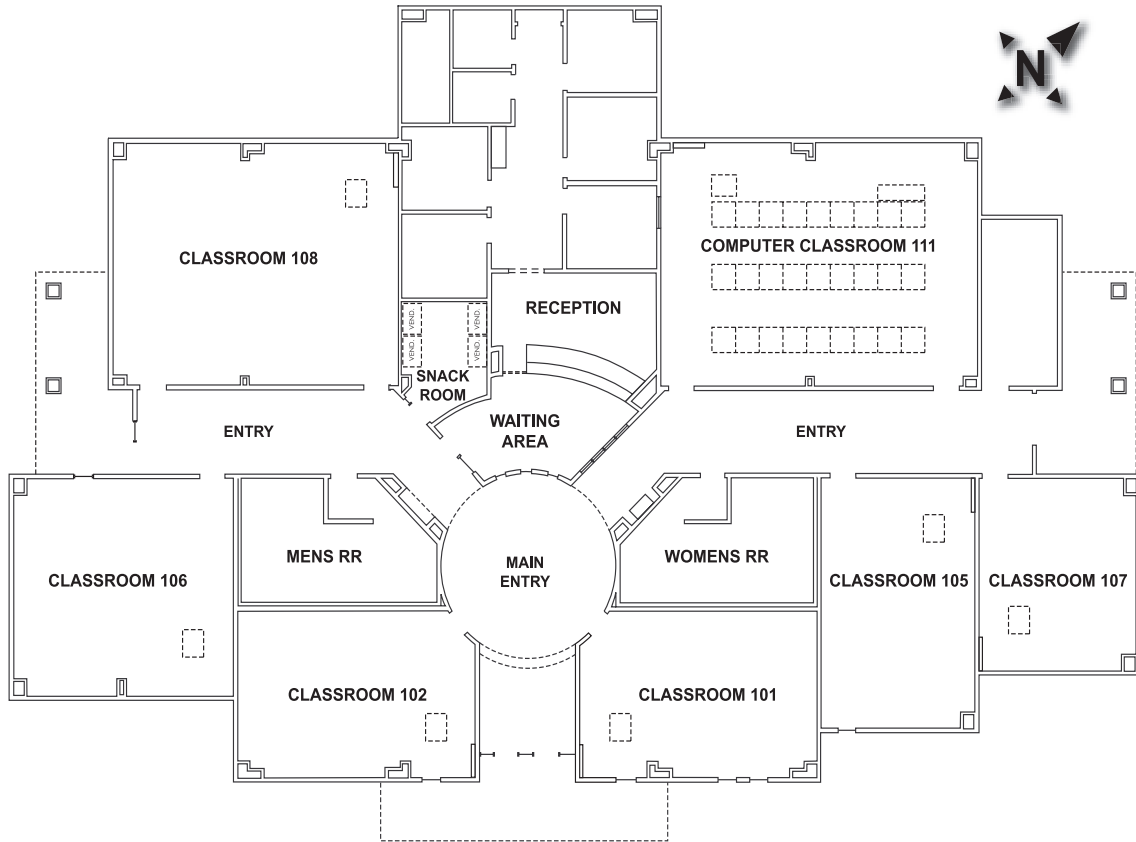

SDSU IVC Campus – Brawley
560 East Highway 78
Brawley, CA 92227
760-351-0806