Imperial Valley Campus

TELEPHONE: 760-768-5500

WEB SITE: <http://www.ivcampus.sdsu.edu>

Administration

Dean: David E. Pearson

Associate Dean for Academic Affairs: Michael J. Sabath

Assistant Dean for Student Affairs: Miguel Rahiotis

Director of Business and Financial Services: Irma Martinez

Director of Advancement:

Faculty

Emeritus: Reynaldo Ayala, David Ballesteros, Breena E. Coates,

Roger M. Dunn, Sergio D. Elizondo, Khosrow Fatemi,

Leslie Garrison, Richard B. Hill, Bonnie Bess King,

Nancy M. Livingston, Frank A. Medeiros, Alfred Merino,

Dana W. Murphy, John L. Polich, Stephen B.W. Roeder,

Richard W. Ryan, José L. Varela-Ibarra

Professors: Donna Castañeda, Laurie Champion, Richard Neumann, Jeanette Shumaker

Associate Professors: Carlos R. Herrera, Gregorio A. Ponce,

Juan Carlos Ramirez-Pimienta, Michael J. Sabath,

Barry G. Stampfl, Diana W. Verzi

Associate Librarian: William R. Payne

Assistant Professors: Lasisi Ajayi, Magdalena Altamirano, Eric Boime,

Elizabeth D. Cordero, Fernando Rodriguez-Valls, Imre Tuba

Lecturers: Suzanna Fuentes, Helina Hoyt, Brett Kofford,

Richard Martin

General Information

The Imperial Valley Campus is a branch campus of San Diego State University serving the desert area of southeastern California. It is accredited as an integral division of SDSU and operates under the same academic calendar. Established in 1959 by an act of the State legislature, the campus offers the last two years of undergraduate education, graduate programs, and fifth year credential programs for teacher preparation. In addition, the Imperial Valley Campus offers, as part of its Freshman Program, first and second year undergraduate education to a select cohort of students planning to major in criminal justice, liberal studies, or psychology. The campus offers students the advantages of smaller classes and individual contact with the faculty. The Imperial Valley Campus faculty are multinational in their classroom orientation and background. Interactive television provides students in Calexico the opportunity to participate in some classes broadcast live from the campus in San Diego. The Imperial Valley Campus schedules many of its classes in three-hour blocks so that students who work full time can earn 9-12 units a semester by attending classes once or twice a week. Occasional classes are also offered on the weekends.

Imperial County has a population of approximately 160,000 people. SDSU-Imperial Valley Campus is located on two sites, Calexico and Brawley. Calexico is 120 miles east of San Diego, 60 miles west of Yuma, Arizona and 120 miles south of Palm Springs. Interstate 8 and State Highways 111 and 86 connect the County to the rest of the country and state. The Calexico location, six blocks from the Mexican border, provides the opportunity for involvement in a bicultural environment. Just across the border is Mexicali, a city of more than one million people. The Brawley location is 24 miles north of the Calexico site. It is surrounded by rich agricultural fields, as agriculture is the largest industry in the Imperial Valley.

Student clubs, student government, lectures, art exhibits, and musical events enhance education for the approximately 1,000 students at SDSU – Imperial Valley Campus.

Curricula Offered

Master's Degrees

Master of Arts in Education

Concentration in Educational Leadership

Concentration in Elementary Curriculum and Instruction

Concentration in Secondary Curriculum and Instruction

Master of Public Administration (in cooperation with the San Diego campus)

Master of Social Work (in cooperation with the San Diego campus)

Certificate Programs

Business Administration

Public Administration

Single Subject Mathematics

Teaching Credentials

Basic

Multiple Subject Teaching Credential

Multiple Subject Bilingual Cross-Cultural Language and

Academic Development (BCLAD): Spanish

Single Subject

Specialist

Administrative Services

Special Education (in conjunction with the College of Education)

Mild/Moderate, Moderate/Severe.

For further information on any of these degrees, see the SDSU – Imperial Valley Campus Bulletin.

Exchange Programs and Study Abroad

Graduate and undergraduate students at the SDSU-Imperial Valley Campus can enhance their education and cultural awareness by taking part in several of the many opportunities available to study abroad. The campus has active exchange agreements with universities in Argentina, Brazil, Ecuador, Finland, France, Germany, Iran, Mexico, and Paraguay.

In addition to the Imperial Valley Campus' own international programs, students may participate in any international program at SDSU, including the California State University International Programs; the SDSU spring semester programs; or the International Student Exchange Program (ISEP) Consortia.

Research Center

Center for Individual and Professional Skills Development Suzanna Fuentes, Director

The Center for Individual and Professional Skills Development at San Diego State University-Imperial Valley Campus offers community programs to the Imperial and Mexicali valleys. The center presently offers English as a Second Language (ESL) in the local community and in Mexico, a teacher training program. Additionally, the Center for Individual and Professional Skills Development presents annual conferences including the Bi-national Conference on Education and the Bi-national Youth Leadership Conference.

Facilities

The Calexico campus is located on an eight-acre city block in the heart of Calexico's civic center along the Mexican border. The campus facilities create a pleasing architectural harmony of old and new structures surrounding a spacious central lawn area, the Rollie Carrillo Quad. Adjoining the quad, the expanded library, Rodney Auditorium, and John Stepling Art Gallery provide academic and cultural resources for the entire community. Other buildings include classroom buildings, the administration building, faculty offices, computer labs, a bookstore, and the Student Union. The Brawley campus is a showcase of the latest instructional technologies, including a computer classroom, a video conference classroom, full computer and Internet presentation capabilities in all classrooms, as well as a computer laboratory for students to research and study individually or in groups.

Imperial Valley Campus

The library, located at the Calexico site, is designed to facilitate research and to provide a pleasant atmosphere for study. The collection is expanding and has more than 110,000 volumes, periodicals, and newspapers which support the curricula offered on the Imperial Valley Campus. Services provided include reference assistance, CD ROM databases, personal computers for word processing, full text database, Internet access, interlibrary loans, and photocopying facilities.

Computer assistance is available in the computer laboratory. Both Macintosh and IBM compatible systems and Internet access are also available on campus.

Admission and Registration

To apply for admission to the Imperial Valley Campus, students complete the CSUMentor application online at <http://www.csumentor.edu> and have transcripts sent to the Office of Admissions, San Diego State University, 5500 Campanile Drive, San Diego, CA 92182-7455. Call 760-768-5667 for additional information. Students can register on the Internet using WebPortal, but only after fees are paid. Late registration is allowed during the first three weeks of the semester. Students wishing to late register must pay registration fees plus a \$25.00 late fee.

Commencement

The Imperial Valley Campus holds its own commencement exercises each spring, in the Rollie Carrillo Quad, prior to commencement exercises on the San Diego campus.



Imperial Valley Campus – Calexico Campus Map

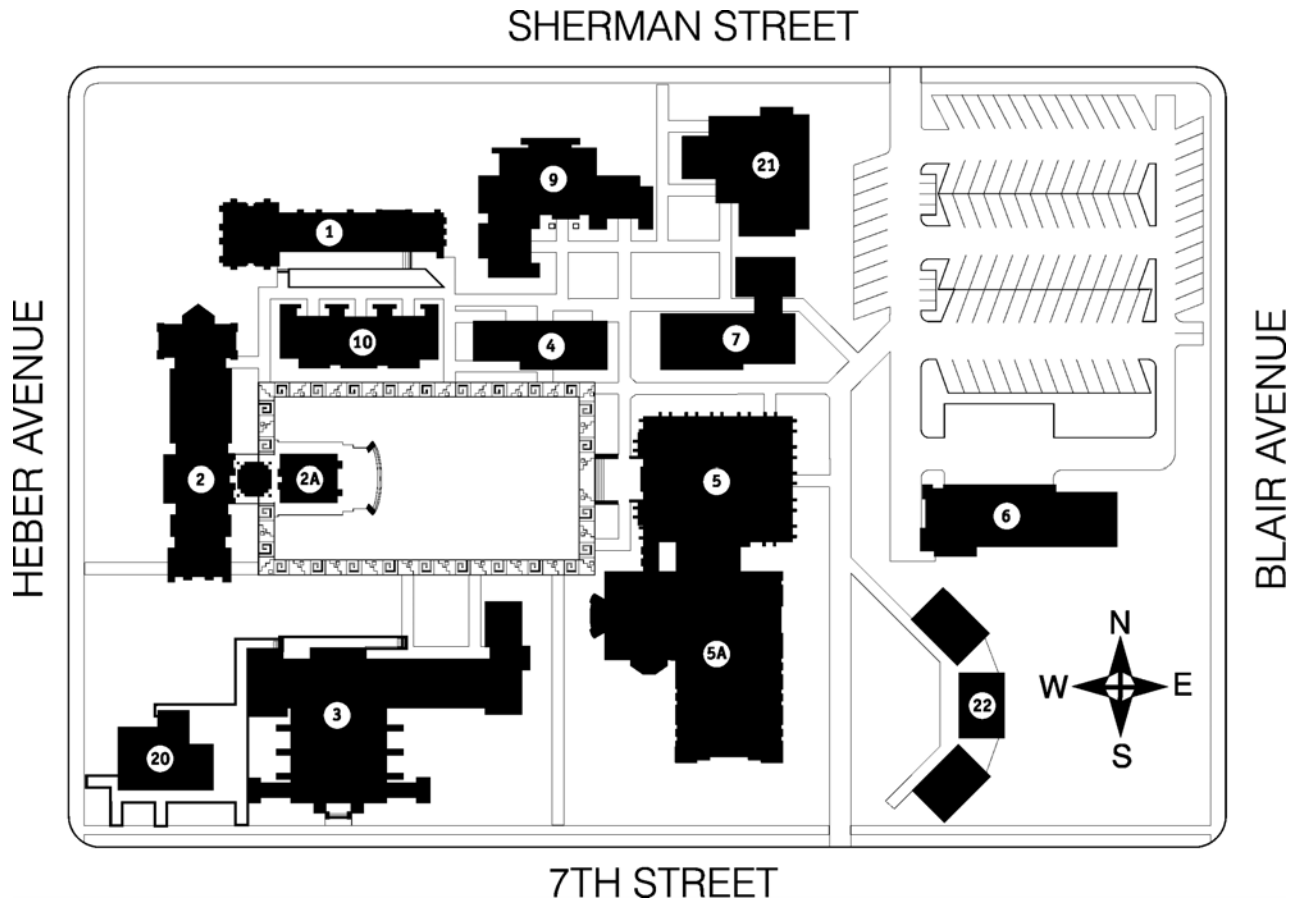

SDSU IVC Campus – Calexico
720 Heber Avenue
Calexico, CA 92231
760-768-5500

IMPERIAL VALLEY CAMPUS BUILDING LEGEND

- | | | |
|---|---|--|
| 1. North Classroom Building (N-101, N-102, N-106, N-108) | 4. Classroom Building (C-7, C-8, C-9, C-10) | 9. Faculty Offices: Building East (Classrooms) |
| 2. Administration Building (Administration/ Academic Affairs/Business Office) | 5. Library | 10. Faculty Offices: Building West |
| 2A. Art Gallery | 5A. Library Addition | 20. Student Center |
| 3. Auditorium/ Classrooms (A-3, LA-1, LA-2, LA-3, LA-4) | 6. Physical Plant | 21. Student Affairs |
| | 7. Computer Building | 22. CLAT – Classrooms |

Imperial Valley Campus – Brawley Campus Map

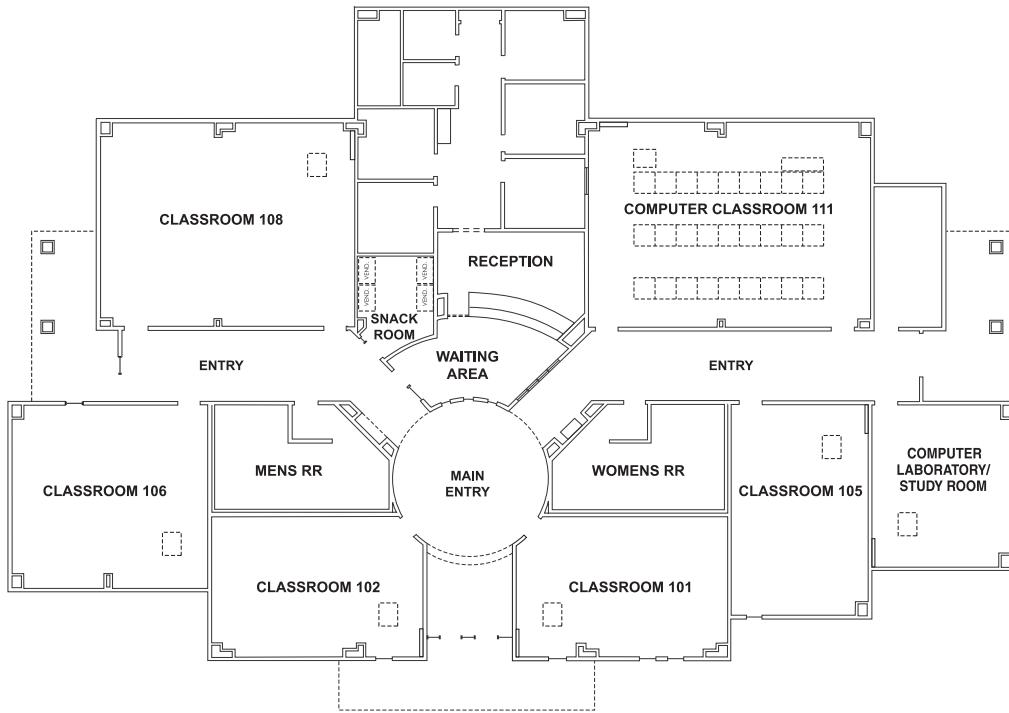

**SDSU IVC Campus – Brawley
560 East Highway 78
Brawley, CA 92227
760-351-0806**