

College of Extended Studies

Section I. Continuing Education

Functions

The California State University regards the credit-bearing programs offered through Extended Education as integral parts of the institution. These programs are viewed as extensions of the institution's educational services and are in concert with the institution's overall mission and purpose. The programs and courses in Extended Education meet the standards of quality that the institution sets for its other programs and courses, with regard to resources, faculty, level of instruction, evaluation, and support services.

The College of Extended Studies at San Diego State University serves as the principal university liaison with the adult community and provides a wide variety of traditional and nontraditional, credit and noncredit, educational experiences designed to fit the life style and expectations of lifelong learners. Under the direction of the dean of the college, programs are developed and carried out within the divisions of Extension, Professional Development, American Language Institute, and Administrative Services. The programs are operated on a self-support basis since state funds are not provided for Continuing Education activities.

Open University

Most regular on-campus courses are open to students through enrollment in Open University. Open University courses earn nonmatriculated resident credit and enrollment for students not seeking an advanced degree or advanced certificate and does not require formal admission to the university. Enrollment in courses through Open University is on a space available basis with the consent of the instructor. Students pay College of Extended Studies fees for these units. The course repeat policy applies to courses repeated through Open University. Consult the College of Extended Studies or the current **Class Schedule** for complete details on Open University qualifications, fees, and registration procedures.

Open University classes may not be taken by the following:

1. Nonmatriculated foreign students (nonresidents from non-English-speaking countries) with a score of less than 550 on the English language test or its equivalent (80 iBT, 6.5 IELTS).
2. Foreign students with I-20 visas from another university.
3. SDSU matriculated students.
4. Disqualified students – Graduate students who have been disqualified from SDSU will not be allowed to attend Open University or classes through Special Sessions for one semester following disqualification.

Limitations on Open University, Special Sessions, and Extension Credit

Matriculated students may **not** enroll in courses through Open University.

Students who have not been admitted to the university may enroll in on-campus courses through Open University during the regular semester on a space available basis with the approval of the course instructor and the department chair. Courses taken through Open University prior to admission to the university may be transferred to meet graduate degree requirements with the approval of the graduate adviser and the graduate dean and are normally limited to nine units depending on the degree objective (see Transfer Credit).

Special Session programs are offered through the College of Extended Studies. A matriculated student who is not in a special sessions program may only take courses through Special Session if the course is not being offered through the regular session, if the student must take the course as part of their program of study, and if the course will not be offered again prior to the student's planned graduation date. In these cases, if the student is taking regular session courses, he or she will have to pay special session fees and regular session fees given they are enrolled in the regular session.

American Language Institute (ALI)

The American Language Institute (ALI) is one of the most prestigious university-based English as a second language (ESL) programs in the US. The ALI is able to offer its students many different programs and courses such as academic, conversational, and business English; TOEFL, IELTS, GRE, and GMAT test preparations; study abroad; and teacher training. Programs offered by the ALI are as follows:

Business English for Global Practices Certificate (BEGP)

This program benefits students interested in learning more about American business practices while also improving their English communication skills. The BEGP program has flexible start dates and does not require an English language examination for admission. <http://ali.sdsu.edu/begp>.

English for Academic Purposes (EAP)

EAP is a full semester or summer term program for students planning to enter San Diego State University or other colleges or universities at the undergraduate level. Classes are offered in academic reading, writing, grammar, listening, note-taking, and speaking. Coursework is available in test preparation, pronunciation, and vocabulary. Students may also choose from over 30 elective course offerings. <http://ali.sdsu.edu/eap>.

Intensive English for Communication (IEC)

IEC is a four or more week program designed for students and professionals at all levels who want to develop and improve their practical English skills. Classes include eight hours of oral communication in addition to 12 hours of reading, writing, grammar, and listening per week. Students can choose from a variety of electives, pronunciation clinics, and sports and conversation clubs. <http://ali.sdsu.edu/iec>.

Pre-MBA and Pre-Master's

This program prepares students for graduate degrees, including MS, MA, and MBA. Coursework includes GRE and GMAT test preparation. <http://ali.sdsu.edu/premba>.

Semester at SDSU

Students who meet SDSU's English proficiency requirement may register for 9 to 12 units through ALI's Semester at SDSU program. <http://ali.sdsu.edu/semester>.

Social Entrepreneurship Certificate (SE)

Students in this certificate program study business trends and innovative entrepreneurs to learn how to create a business that will positively impact society. This program has flexible start dates. <http://ali.sdsu.edu/se>.

Teaching English as a Second or Foreign Language Certificate (TESL/TEFL)

The ALI offers a TESL/TEFL certificate program for those with little or no previous English language teaching experience who would like to teach English abroad. <http://ali.sdsu.edu/teslteflcertificate>.

Customized Group Programs

The ALI offers customized English as a second language (ESL) programs for specialized adult groups in fields such as business, teacher training, law, health care, sports medicine, and others.

Services

All full-time students at the institute are offered visa and immigration support and assistance, housing assistance, organized volunteer activities, field trips to popular tourist attractions, advising for university entrance, health services, and orientation to university life. Many SDSU campus facilities and activities are also available to ALI students. For the most current and detailed information on how to apply, please see the ALI website at <http://ali.sdsu.edu> or call 619-594-5907.

Osher Lifelong Learning Institute

The Osher Lifelong Learning Institute offers instructor-led university inspired courses for people age 50 and better who are interested in meaningful intellectual and social engagement. Classes are held on the SDSU campus, with opportunities to attend special events and adventures (educational excursions) at various locations. Course topics include art, culture, current events, history, literature, music, religion, science, and more. Courses are intellectually stimulating without the pressure of grades, tests, or papers. For more information, call 619-594-2863, e-mail osher@mail.sdsu.edu or visit the website at: <http://neverstoplearning.net/osher>.

Certificate Programs

A complete listing of certificate programs is in the Curricula Summary section of this bulletin.

Section II. University Degree Programs

From time to time, the university offers specialized advanced degree programs through the College of Extended Studies designed to serve unique groups of students and the special needs of the community. These programs conform to the standards and requirements established by the Graduate Council for all graduate degree curricula. Students enrolling in these programs are fully matriculated and are expected to fulfill all of the academic requirements as described in this Bulletin, including formal admission to the university and to the individual program.

Because of the special nature of these programs, scheduling of courses may not follow the traditional semester schedule. This allows maximum flexibility in the modes, timing, and place of instruction that will best serve the needs of the participating groups. These programs are not supported by the state; correspondingly, the fee structure is different from that listed in this bulletin. Once accepted into the program, students register for classes and pay fees through the College of Extended Studies. Since these fees cover only the cost of instruction, students who desire access to such services of the associated students as health and placement will be required to pay additional fees on campus.

The following programs described in detail in Part Five of this Bulletin are currently offered through special arrangements with the College of Extended Studies. Persons interested in further information are invited to contact the program coordinator.

Master of Business Administration for Executives (M.B.A.)

A two year program designed for mid-career business executives who have substantial work and managerial experience. Classes meet on alternate Fridays and Saturdays. Approximate cost: \$54,000.

Master of Business Administration with a Specialization in Sports Business Management (M.B.A.)

A 49 unit full time program in the management of sports organizations and related facilities. A four- to six-month internship in a representative organization is an integral component of the program. Elective coursework will emphasize sport and event marketing, community relations, collective bargaining, and legal issues. Approximate cost: \$46,000.

Master of Arts in Education with Concentration in Learning Design and Technology

This 30 unit program is available online and enables students to prepare for careers as instructional technologists, educational specialists, instructional designers, trainers, and experts in educational computing. State-of-the-art coursework and internships in companies, agencies, and schools prepare candidates to analyze performance problems and design, develop, and evaluate instructional strategies and products. Students graduate with a portfolio including educational computer software, video, multimedia, print and web-based materials. Approximate cost: \$20,000.

Master of Arts in Education with Concentration in Educational Leadership: Specialization in PreK-12

This 15-month program is available online and is designed for school administrators and teachers who aspire to a leadership role in educational technology within their school, district, or county office of education. The program is a collaboration between San Diego State University and the San Diego County Office of Education. Approximate cost: \$15,300.

Master of Public Administration

This competitive 16-month online degree program is offered to experienced professionals who currently work in government and nonprofit agencies. The rigorous format has been designed for working professionals who are currently employed in managerial positions in public administration, non-profit administration, urban planning, criminal justice, or related fields. Past experience in these fields will be considered for applicants who are not currently working in the public or non-profit sector. The 36-unit curriculum is the same as the campus-based program; however, the fast-track, online program is taught in six, two-month modules with two on-campus experiences – one at the beginning and one at the end of the program.

Master of Science in Computational Science with Concentration in Professional Applications

No students admitted to program at this time.

This program focuses on professional applications of computational science. The program leads to careers in management of technology in a wide variety of fields. To enter, students must possess a bachelor's degree with a strong mathematical background. The student must complete a graduate program of 40 units. Approximate cost: \$29,000.

Master of Science in Hospitality and Tourism Management

This 30 unit master's program is designed for experienced professionals and leaders in the hospitality, tourism, and recreation industry who desire a cutting edge program while continuing to work in their current position. Crafted as a 15-month program with 80% of the coursework online and an intensive on-campus week staged at the beginning and at the end of the program, working professionals are challenged by seasoned faculty to become the next generation of leaders in the industry. The curriculum emphasizes the knowledge and concrete skills that 21st century leaders must command in order to be successful in leading hospitality, tourism, and recreation organizations into the 2020s and beyond. Approximate cost: \$29,250.

Master of Science in Regulatory Affairs

This 39 unit interdisciplinary program is designed for regulatory affairs professionals and focuses on the laws and regulations imposed by the Federal government, especially the Food and Drug Administration. Particular concerns are related to drug discovery, development, testing, and manufacture of products for commercial distribution. Approximate cost, excluding course materials: \$23,000.

Master of Science in Rehabilitation Counseling

A three year, 60 semester hour program, designed for currently employed rehabilitation personnel who are counselors and service providers. Courses are offered throughout the calendar year. There is extensive use of mediated technologies. Approximate cost, excluding books: \$18,000.

Library and Information Access

Administration

Dean: Gale S. Etschmaier
Associate Dean: Patrick McCarthy
Director of Access Services and Human Resources: Sara Baird
Director of Budget and Fiscal Operations: Sallee Spearman
Director of Development: Michelle LaGrandeur
Director of Information Technologies and Digital Initiatives: Mark Figueroa

Faculty

Emeritus: Carande, Cargille, Coleman, Dickinson, Dintrone, Fikes, Goodwin, Goynes, Harkányi, Harris, Johns, Leerhoff, McPhail, Palsson, Pease, Perkins, Puerto, Rogers, Sonntag, Sullivan, Turhollow, White, Wilson
Librarians: Baber, Harley, Jackson, Muroi, Salem, Savage, Su
Associate Librarians: Bliss, Jeffery, Kiczek, Lamont, Payne, Ray, Rhodes, Tumlin, Weston
Senior Assistant Librarians: Culbertson, Houk, Jarocki, Lanthorne, Nielsen, Wong-Welch

General Information

Located in the center of campus, Library and Information Access empowers students and faculty to explore ideas, collaborate with colleagues, develop projects, create knowledge, and cultivate academic success. The library is comprised of two buildings, the five-story Love Library and the Library Addition, with its landmark dome. Spanning more than 500,000 square feet, with nearly 4,000 seats for study and research, the library's importance to students, faculty, staff, and individuals living in the San Diego region is documented by more than 2.2 million annual visits.

Hours and Access

The library is open to the public except on holidays, recess dates, and between midnight to 7:00 a.m. When the main library is closed, the 24/7 Study Area is open only to current SDSU students, staff, and faculty. Hours are posted online or call 619-594-6721.

Registering for a library PIN provides SDSU affiliates with access to online full-text articles from peer-reviewed journals. Students can find the library's catalog, course guides, subject guides for each major, and more at <http://library.sdsu.edu/>.

Library Services

Librarians provide research assistance in person, telephone, e-mail, and online chat. They serve as subject specialists providing in-depth research support for each major on campus. The library has a comprehensive teaching program, which includes course-related instruction, online tutorials, blogs, videos, and tours.

University tutoring programs are hosted by the library in the Math Learning Center and the Writing Center.

The Library Computing Hub operates an extensive computer laboratory with over 300 computers, both Mac and PC. Resources include a help desk and access to a variety of applications. BuildIT, a makerspace with 3-D scanning and printing for students is located within the Hub.

Library Print Services also offers copying, poster printing, and instruction on SDSUcard use. Students can borrow a variety of equipment through the library, such as cameras, laptops, cables, and more.

The Wells Fargo Financial Laboratory, staffed by the College of Business Administration, is hosted in the library with 12 Bloomberg terminals for real-time financial literacy education for interested students. Fifty group study rooms can be found throughout the library. Reservations are required for rooms with technology, such as large collaborative monitors or presentation practice equipment. There are also food friendly areas, quiet study locations, and a coffee cart.

Holdings

The library's holdings exceed two million print titles with over 776,000 electronic books. With robust access to journals, the library transmits over one million articles annually. We maintain 23 unique collections of digital materials, having scanned over 90,000 items including, maps, photos, audio and video recordings, archival papers, and more. The library is also a depository for United States and California government publications.

Requests for books not available at SDSU can be made online or at an information desk. Partnerships with local Circuit libraries, the global catalog WorldCat, and interlibrary loans support the delivery of items.

For help finding materials, students can consult staff at service desks located in Research Services, Circulation/Course Reserves, Media Center, and Special Collections and University Archives.

Special Collections and University Archives

Special Collections and University Archives houses rare, unique, and valuable books, periodicals, manuscripts, and documents which require care in handling. Ephemera, such as art prints, etchings, memorabilia, photographs, and postcards are kept in this area. Significant holdings include an extensive science fiction collection, comics and zines, and historical archives of the university. Noteworthy regional history collections include items from the civil rights era and the Chicano movement.

Students and researchers are encouraged to make use of these items in the adjoining Reading Room.

Imperial Valley Campus

TELEPHONE: 760-768-5500

WEBSITE: <http://www.ivcampus.sdsu.edu>

Administration

Dean: Gregorio A. Ponce (Interim)

Associate Dean for Academic Affairs: Carlos R. Herrera

Assistant Dean for Student Affairs: Miguel Rahiotis

Director of Business and Financial Services: Martha P. Garcia

Director of Development and Community Relations: Valorie A. Ashley

Director of Student Affairs: Miriam Castañon

Faculty

Emeritus: Ayala, Ballesteros, Coates, Dunn, Fatemi, Garrison, Hill, Livingston, Medeiros, Merino, Murphy, Polich, Ponce, Roeder, Ryan, Sabath, Varela-Ibarra

Professors: Castañeda, Champion, Neumann, Pearson, Ramirez-Pimienta, Shumaker, Verzi

Associate Professors: Altamirano, Boime, Cordero, Herrera, Stampfl

Associate Librarian: Payne

Assistant Professors: Abarbanell, Braun, Camargo

Lecturers: Fuentes, Hoyt, Kofford

General Information

The Imperial Valley Campus is a branch campus of San Diego State University serving the people of southeastern California. It is accredited as an integral division of SDSU and operates under the same academic calendar. Established in 1959, by an act of the State legislature, the campus offers the last two years of undergraduate education, graduate programs, and fifth year credential programs for teacher preparation. In addition, the Imperial Valley Campus offers first and second year undergraduate education through the Imperial Valley University Partnership, an innovative collaboration between SDSU-IV, Imperial Valley College, and the Imperial County Office of Education, to students planning to major in criminal justice, history, liberal studies, psychology, public administration, or Spanish (available for students who have received a score of 3 or higher on the Spanish Language Advanced Placement examination). Imperial Valley Campus faculty are multinational in their classroom orientation and background. Smart classroom technology provides students the opportunity to participate in some classes broadcast live from the campus in San Diego. The Imperial Valley Campus schedules many of its classes in three-hour blocks so that students who work full-time can earn 9-12 units a semester by attending classes once or twice a week. Some classes are also offered on the weekends.

Student clubs, student government, lectures, art exhibits, and musical events enhance education for the approximately 1,000 students at SDSU – Imperial Valley Campus.

Location

Imperial County has a population of approximately 180,000 people. SDSU-IV is located on two sites, Calexico and Brawley. Calexico is 110 miles east of San Diego, 55 miles west of Yuma, Arizona, and 120 miles south of Palm Springs. Interstate 8 and State Highways 111 and 86 connect the County to the rest of the country and state. The Calexico location, six blocks from the Mexican border, provides the opportunity for involvement in a bicultural environment. Just across the border is Mexicali, a city of more than one million people. The Brawley location is 24 miles north of the Calexico site. It is surrounded by rich agricultural fields and a rapidly emerging renewable energy industry.

Curricula Offered

Master's Degrees

Master of Arts in Education

Concentration in Educational Leadership

Concentration in Elementary Curriculum and Instruction

Concentration in Secondary Curriculum and Instruction

Master of Social Work (in cooperation with the San Diego campus)

Certificate Programs

Business Administration (*Currently not admitting new students*)

Public Administration

Single Subject Mathematics

Teaching Credentials

Basic

Multiple Subject

Multiple Subject with Bilingual Authorization: Spanish

Single Subject

Single Subject with Bilingual Authorization: Spanish

Specialist

Administrative Services

Special Education (in conjunction with the College of Education)

Mild/Moderate, Moderate/Severe.

For further information on any of these degrees, see the SDSU – *Imperial Valley Campus Bulletin*.

Exchange Programs and Study Abroad

Graduate and undergraduate students at the SDSU-Imperial Valley Campus can enhance their education and cultural awareness by taking part in several of the many opportunities available to study abroad.

SDSU offers over 350 education abroad programs in more than 50 countries. In addition to SDSU's own study abroad programs, students may participate in the California State University International Programs; the International Student Exchange Program (ISEP) Consortia; and other independent programs.

Research Centers

Center for Individual and Professional Skills Development Suzanna Fuentes, Director

The Center for Individual and Professional Skills Development at San Diego State University-Imperial Valley Campus offers community programs to the Imperial and Mexicali valleys. The center offers English as a second language (ESL) courses in the local community and a teacher training program in Mexico. Additionally, the Center for Individual and Professional Skills Development presents annual conferences including the Bi-national Conference on Education and the Bi-national Youth Leadership Conference.

USDA-HSI and SDSU-Imperial Valley Campus Partnership

**Roberto González, Jr., Regional Director for
Southern California and Arizona**

The USDA-HSI national program promotes partnerships and collaborations between U.S. Department of Agriculture (USDA) agencies and Hispanic Serving Institutions (HSIs). The partnership cultivates knowledge and develops leaders by linking USDA and higher education. For more information, stop by the Administration Building at SDSU Imperial Valley Campus.

Facilities

The Calexico campus is located on an eight-acre city block in the heart of Calexico's civic center along the Mexican border. The campus facilities create a pleasing architectural harmony of old and new structures surrounding a spacious central lawn area, the Rollie Carrillo Quad. Adjoining the quad, the library, Joseph Rodney Auditorium, and John Steppling Art Gallery provide academic and cultural resources for the entire community. Other buildings include classroom buildings, the administration building, faculty offices, computer labs, a bookstore, and the Student Union. The Brawley campus is a showcase of the latest instructional technologies, including a computer classroom, a video conference classroom, full computer and Internet presentation capabilities in all classrooms, as well as a computer laboratory for students to research and study individually or in groups. The Brawley campus is also the site of the Center for Energy Sustainability and its numerous renewable energy projects.

The library, located at the Calexico site, is designed to facilitate research and to provide a pleasant atmosphere for study. The collection's volumes, periodicals, and newspapers support the curricula offered on the Imperial Valley Campus. Services provided include reference assistance, CD ROM databases, personal computers for word processing, full text database, Internet access, interlibrary loans, and photocopying facilities.

Computer assistance is available in the computer laboratory. Both Macintosh and IBM compatible systems and Internet access are also available on campus.

Transfer Center

The Transfer Center provides support services to identified and potential transfer students from accredited institutions. Information is provided by a professional counselor about programs and services available at San Diego State University, Imperial Valley Campus. The transfer center works with all students, and has among its goals to increase the number of underrepresented students in higher education. Underrepresented students are minorities, disabled, low income, and others not proportionately represented among the transfer population. For more information, call 760-768-5506, visit the office located in Student Affairs, or go to <http://www.ivcampus.sdsu.edu/transfer>.

Admission and Registration

To apply for admission to the Imperial Valley Campus, students complete the CSUMentor application online at <http://www.csumentor.edu> and have transcripts sent to the Office of Admissions, San Diego State University, 5500 Campanile Drive, San Diego, CA 92182-7455. Call 760-768-5667 for additional information.

After students have been admitted, they can register on the Internet using WebPortal, but only after fees are paid. Late registration is allowed during the first three weeks of the semester. Students wishing to late register must pay registration fees plus a \$25.00 late fee.

Imperial Valley Campus – Calexico Campus Map

SDSU IVC Campus – Calexico
720 Heber Avenue
Calexico, CA 92231
760-768-5500

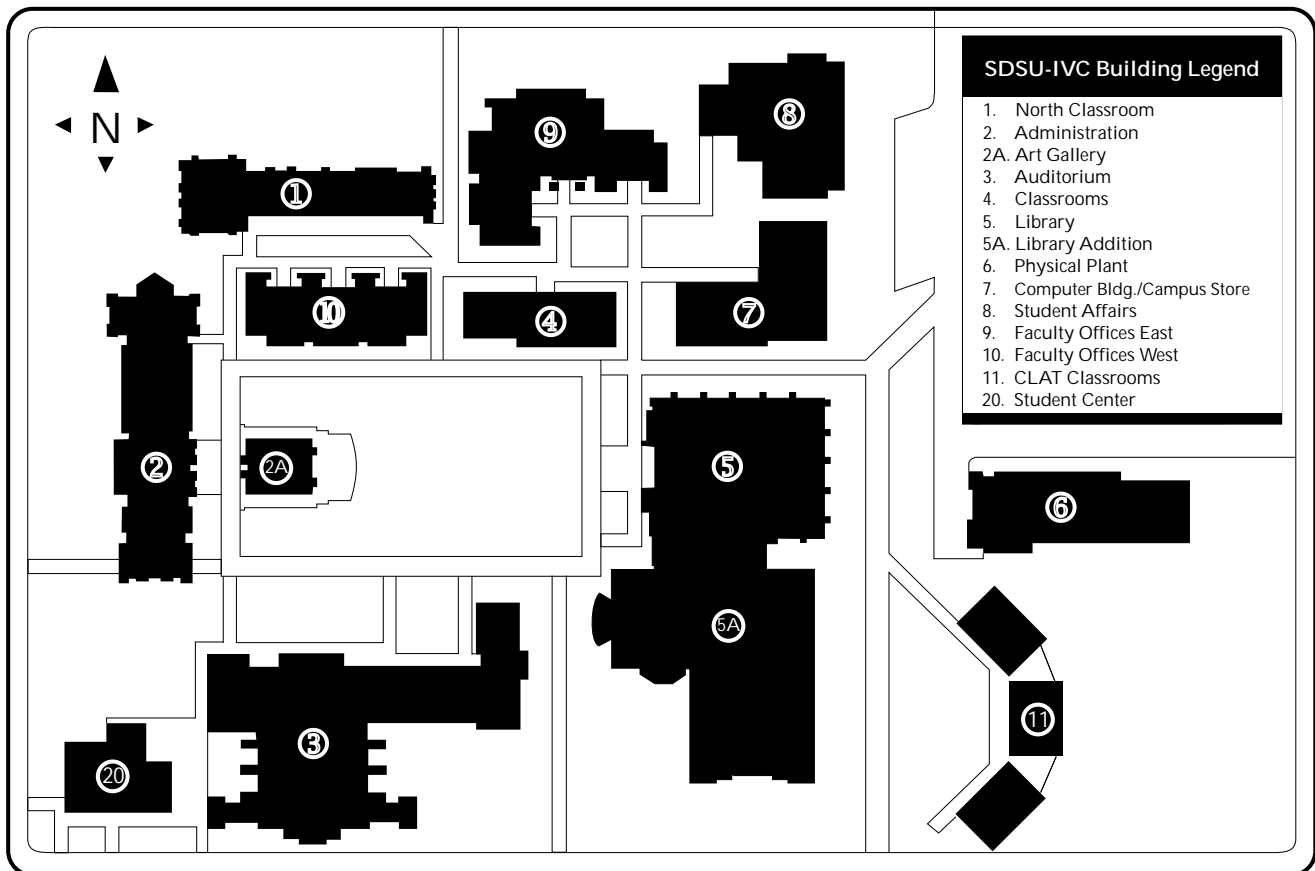

Imperial Valley Campus – Brawley Campus Map

SDSU IVC Campus – Brawley
560 East Highway 78
Brawley, CA 92227
760-351-0806

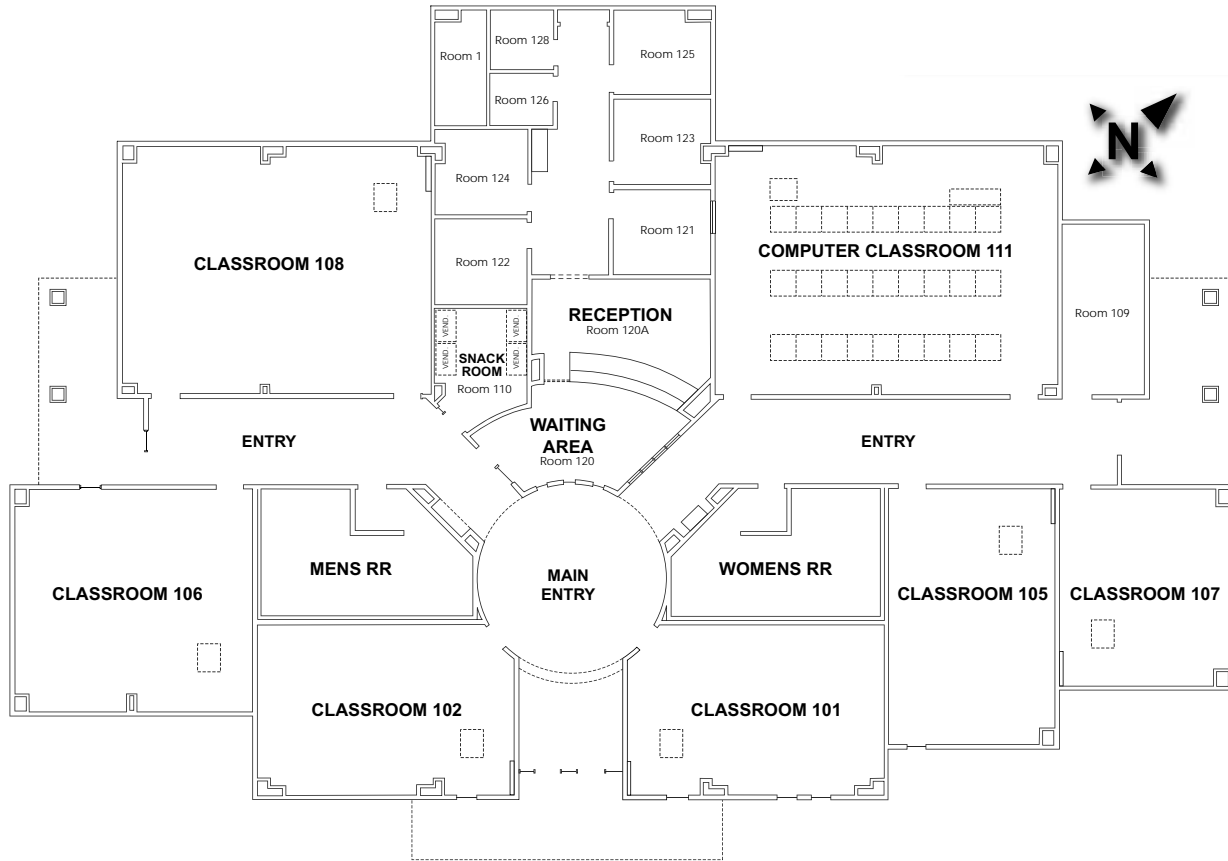

The California State University

Welcome to the California State University (CSU) – the world's largest comprehensive higher education system in the nation with 23 unique campuses serving more than 470,000 students with 47,000 employees statewide. Each year, the university awards more than 100,000 degrees. CSU graduates now total more than three million strong, and are serving as leaders in the industries that drive California's economy, including business, agriculture, entertainment, engineering, teaching, hospitality, and healthcare. Learn more at www.calstate.edu.

More than 50-Year Tradition of Excellence

Since 1961, the CSU has provided an affordable, accessible, and high-quality education to three million graduates around the state of California. While each campus is unique based on its curricular specialties, location and campus culture, every CSU is distinguished for the quality of its educational programs. All campuses are fully accredited, provide a high-quality broad liberal educational program and offer opportunities for students to engage in campus life through the Associated Students, Inc., clubs and service learning. Through leading-edge programs, superior teaching and extensive workforce training opportunities, CSU students graduate with the critical thinking skills, industry knowledge and hands-on experience necessary for employment and career advancement.

Facts

- CSU faculty attract nearly \$540 million annually in research and education grants, and contracts by federal, state, and regional agencies.
- Today, one of every 20 Americans with a college degree is a CSU graduate.
- One in every 10 employees in California is a CSU alumnus.
- The CSU awards 43 percent of the bachelor's degrees earned in California.
- Almost half of all the nurses in the state earn their degrees from the CSU.
- The CSU awards 95 percent of the hospitality/tourism degrees in the state.
- Nearly half of all of the state's engineers earn their degrees from the CSU.
- The CSU is the leading provider of teacher preparation programs in the state.
- The CSU offers more than 104 fully online and 69 hybrid degree programs and concentrations.
- The CSU offers 3,253 online courses to provide more educational options to students who may prefer an online format to a traditional classroom setting.
- The CSU's growing online concurrent enrollment program gives students the ability to enroll in courses offered by other campuses in the CSU system.
- Over the past four years, the CSU has issued nearly 50,000 professional development certificates in education, health services, business and technology, leisure and hospitality, manufacturing, international trade, and many other industries.
- Nearly half of the CSU's 470,000 students are engaged in some type of community service, totaling 32 million hours of service annually.
- More than 11,000 students participate in STEM (science, technology, engineering, and mathematics) service-learning courses.
- For every \$1 that the state invests in the CSU, the university generates \$5.43 for California's economy.

Governance

The Board of Trustees, most of who are appointed by the governor and serve with faculty and student representatives, govern the system. The CSU Chancellor is the chief executive officer, reporting to the board. The campus presidents serve as the campus-level chief executive officers. The trustees, chancellor, and presidents develop systemwide educational policy. The presidents, in consultation with the Academic Senate and other campus stakeholder groups, render and implement local policy decisions.

CSU Historical Milestones

The Donahoe Higher Education Act established the individual California State Colleges as a system with a Board of Trustees and a Chancellor in 1960. In 1972, the system was designated as the California State University and Colleges, and in 1982 the system became the California State University. Today, the CSU is comprised of 23 campuses, including comprehensive and polytechnic universities and, since July 1995, the California Maritime Academy, a specialized campus.

The oldest campus—San José State University—was founded in 1857 and became the first institution of public higher education in California. The newest—CSU Channel Islands—opened in fall 2002, with freshmen arriving in fall 2003.

In 1963, the State Academic Senate was established to act as the official voice of CSU faculty in systemwide matters. Also, the California State College Student Presidents Association—which was later renamed the California State Students Association—was founded to represent each campus student association on issues affecting students.

Through its many decades of existence, the CSU has continued to adapt to address societal changes, student needs and workforce trends. While the CSU's core mission has always focused on providing high-quality, affordable bachelor's and master's degree programs, over time the university has added a wide range of services and programs to support student success – from adding health centers and special programs for veterans to building student residential facilities to provide a comprehensive educational experience.

To improve degree completion and accommodate students working full- or part-time, the educational paradigm expanded to give students the ability to complete upper-division and graduate requirements through part-time, late afternoon, and evening study. The university also expanded its programs to include a variety of teaching and school service credential programs, specially designed for working professionals.

The CSU marked another significant educational milestone when it broadened its degree offerings to include doctoral degrees. The CSU independently offers educational doctorate (Ed.D.), Doctor of Physical Therapy (DPT), and Doctor of Nursing Practice (DNP) degree programs. A limited number of other doctoral degrees are offered jointly with the University of California and private institutions in California.

In an effort to accommodate community college transfer students, the CSU, in concert with the California Community Colleges, launched the Associate Degree for Transfer, which guarantees admission to the CSU with junior status for transfer students who earn the AA-T or AS-T degrees.

Always adapting to changes in technology and societal trends to support student learning and degree completion, the CSU initiated another milestone in 2013, when it launched CalState Online, a systemwide collection of services that support the delivery of fully online programs from campuses. Now, full-time students also have access to fully online courses offered at other CSU campuses.

By providing an accessible, hands-on education that prepares graduates for career success, the CSU has created a network of alumni that is so extensive and renowned that it spans across the globe. In 2014-15, the CSU celebrated The Class of 3 Million, the year-round campaign celebrating the three million alumni from all of CSU's campuses, including the Class of 2015.

The CSU strives to continually develop innovative programs, services, and opportunities that will give students the tools they need to meet their full potential. With 23 campuses, 470,000 students and 47,000 faculty and staff, the CSU is committed to providing a quality higher education that prepares students to become leaders in the changing workforce.

Average Support Cost Per Full-time Equivalent Student and Sources of Funds

The total support cost per full-time equivalent student (FTES) includes the expenditures for current operations, including payments made to students in the form of financial aid, and all fully reimbursed programs contained in state appropriations. The average support cost is determined by dividing the total cost by the number of FTES. The total CSU 2015-16 budget amounts were \$2,987,063,000 from state General Fund (GF) appropriations and before adding \$20.5 million CalPERS retirement adjustment, \$1,654,161,000 from tuition fee revenue and after tuition fee discounts (forgone revenue), and \$491,651,000 from other fee revenues for a total of \$5,132,875,000. The 2015-16 resident FTES target is 356,450 and the nonresident FTES based on past-year actual is 18,630 for a total of 375,080 FTES. The GF appropriation is applicable to resident students only whereas fee revenues are collected from resident and nonresident students. FTES is determined by dividing the total academic student load (e.g. 15 units per semester) (the figure used here to define a full-time student's academic load).

The 2015-16 average support cost per FTES based on GF appropriation and net tuition fee revenue only is \$12,790 and when including all sources as indicated below is \$14,101, which includes all fee revenue (e.g. tuition fees, application fees, and other campus mandatory fees) in the CSU Operating Fund. Of this amount, the average net tuition and other fee revenue per FTES is \$5,721.

The average CSU 2015-16 academic year, resident, undergraduate student basic tuition fee and other mandatory fees required to apply to, enroll in, or attend the university is \$6,815 (\$5,472 tuition fee plus \$1,343 average campus-based fees). However, the costs paid by individual students will vary depending on campus, program, and whether a student is part-time, full-time, resident, or nonresident.

2015-16	Amount	Average Cost Per	
		FTES	Percentage
• State Appropriation (GF) ¹	2,987,063,000	8,380	59.4%
• Net Tuition Fee Revenue ²	1,654,161,000	4,410	31.3%
• Other Fees Revenue ²	491,651,000	1,311	9.3%
Total Support Cost	\$5,132,875,000	\$14,101	100%

¹ Represents state GF appropriation in the Budget Act of 2015-16; GF is divisible by resident students only (356,450 FTES).

² Represents CSU Operating Fund, Tuition Fee and other fees revenue amounts (net of tuition fee discounts) submitted in campus August 2015-16 final budgets. Revenues are divisible by resident and nonresident students (375,080 FTES).

Trustees of The California State University

Ex Officio Trustees

- The Honorable Edmund G. Brown, Jr.
Governor of California
- The Honorable Gavin Newsom
Lieutenant Governor of California
- The Honorable Toni G. Atkins
Speaker of the Assembly
- The Honorable Tom Torlakson
State Superintendent of Public Instruction
- Dr. Timothy P. White
Chancellor of The California State University

Officers of the Trustees

- The Honorable Edmund G. Brown, Jr.
President
- Mr. Lou Monville
Chair
- Ms. Rebecca D. Eisen
Vice Chair
- Mr. Framroze Virjee
Secretary
- Mr. Steve Relyea
Treasurer

Appointed Trustees

Appointments are for a term of eight years, except student, alumni, and faculty trustees whose terms are for two years. Terms expire in the year in parentheses. Names are listed alphabetically.

- Silas Abrego (2021)
- Kelsey Brewer (2016)
- Adam Day (2023)
- Rebecca D. Eisen (2018)
- Douglas Faigin (2017)
- Debra S. Farar (2022)
- Margaret Fortune (2016)
- Lupe C. Garcia (2020)
- Lillian Kimbell (2016)
- Lou Monville (2016)
- Hugo N. Morales (2020)
- J. Lawrence Norton (2019)
- Steven Stepanek (2017)
- Peter J. Taylor (2021)
- Maggie White (2017)

Correspondence with Trustees should be sent to:
c/o Trustees Secretariat
The California State University
401 Golden Shore
Long Beach, CA 90802-4210

Office of the Chancellor

The California State University
401 Golden Shore
Long Beach, CA 90802-4210
Telephone: 562-951-4000

- Dr. Timothy P. White..... Chancellor — CSU System
- Mr. Steve Relyea..... Executive Vice Chancellor and Chief Financial Officer
- Dr. Loren J. Blanchard..... Executive Vice Chancellor, Academic and Student Affairs
- Mr. Framroze Virjee.... Executive Vice Chancellor and General Counsel
- Mr. Garrett P. Ashley Vice Chancellor, University Relations and Advancement
- Ms. Lori Lamb..... Vice Chancellor, Human Resources
- Mr. Larry Mandel Vice Chancellor and Chief University Auditor

Campuses — The California State University

CALIFORNIA STATE UNIVERSITY, BAKERSFIELD

9001 Stockdale Highway, Bakersfield, CA 93311-1022
Dr. Horace Mitchell, President
661-654-2782 • <http://www.csub.edu>

CALIFORNIA STATE UNIVERSITY, CHANNEL ISLANDS

One University Drive, Camarillo, CA 93012
Dr. Richard R. Rush, President
805-437-8400 • <http://www.csuci.edu>

CALIFORNIA STATE UNIVERSITY, CHICO

400 West First Street, Chico, CA 95929
Dr. Paul J. Zingg, President
530-898-4636 • <http://www.csuchico.edu>

CALIFORNIA STATE UNIVERSITY, DOMINGUEZ HILLS

1000 EAST VICTORIA STREET, CARSON, CA 90747
Dr. WILLIE HAGAN, PRESIDENT
310-243-3696 • <http://www.csudh.edu>

CALIFORNIA STATE UNIVERSITY, EAST BAY

25800 Carlos Bee Boulevard, Hayward, CA 94542
Dr. Leroy M. Morishita, President
510-885-3000 • <http://www.csueastbay.edu>

CALIFORNIA STATE UNIVERSITY, FRESNO

5241 North Maple Avenue, Fresno, CA 93740
Dr. Joseph I. Castro, President
559-278-4240 • <http://www.csufresno.edu>

CALIFORNIA STATE UNIVERSITY, FULLERTON

800 N. State College Boulevard, Fullerton, CA 92831-3599
Dr. Mildred Garcia, President
657-278-2011 • <http://www.fullerton.edu>

HUMBOLDT STATE UNIVERSITY

1 Harpst Street, Arcata, CA 95521-8299
Dr. Lisa Rossbacher, President
707-826-3011 • <http://www.humboldt.edu>

CALIFORNIA STATE UNIVERSITY, LONG BEACH

1250 Bellflower Boulevard, Long Beach, CA 90840-0115
Dr. Jane Close Conoley, President
562-985-4111 • <http://www.csulb.edu>

CALIFORNIA STATE UNIVERSITY, LOS ANGELES

5151 State University Drive, Los Angeles, CA 90032
Dr. William A. Covino, President
323-343-3000 • <http://www.calstatela.edu>

CALIFORNIA MARITIME ACADEMY

200 Maritime Academy Drive, Vallejo, CA 94590
Rear Admiral Thomas A. Cropper, President
707-654-1000 • <http://www.csum.edu>

CALIFORNIA STATE UNIVERSITY, MONTEREY BAY

100 Campus Center, Seaside, CA 93955-8001
Dr. Eduardo M. Ochoa, President
831-582-3000 • <http://www.csUMB.edu>

CALIFORNIA STATE UNIVERSITY, NORTHRIDGE

18111 Nordhoff Street, Northridge, CA 91330
Dr. Dianne F. Harrison, President
818-677-1200 • <http://www.csun.edu>

CALIFORNIA STATE POLYTECHNIC UNIVERSITY, POMONA

3801 West Temple Avenue, Pomona, CA 91768
Dr. Soraya M. Coley, President
909-869-7659 • <http://www.cpp.edu>

CALIFORNIA STATE UNIVERSITY, SACRAMENTO

6000 J Street, Sacramento, CA 95819
Dr. Robert S. Nelsen, President
916-278-6011 • <http://www.csus.edu>

CALIFORNIA STATE UNIVERSITY, SAN BERNARDINO

5500 University Parkway, San Bernardino, CA 92407-2318
Dr. Tomás D. Morales, President
909-537-5000 • <http://www.csusb.edu>

SAN DIEGO STATE UNIVERSITY

5500 Campanile Drive, San Diego, CA 92182
Dr. Elliot Hirshman, President
619-594-5200 • <http://www.sdsu.edu>

*IMPERIAL VALLEY CAMPUS
720 Heber Avenue, Calexico, CA 92231
760-768-5500 • <http://www.ivcampus.sdsu.edu>

SAN FRANCISCO STATE UNIVERSITY

1600 Holloway Avenue, San Francisco, CA 94132
Dr. Leslie E. Wong, President
415-338-1111 • <http://www.sfsu.edu>

SAN JOSÉ STATE UNIVERSITY

One Washington Square, San Jose, CA 95192-0001
Dr. Susan W. Martin, President
408-924-1000 • <http://www.sjsu.edu>

CALIFORNIA POLYTECHNIC STATE UNIVERSITY, SAN LUIS OBISPO

One Grand Avenue, San Luis Obispo, CA 93407
Dr. Jeffrey D. Armstrong, President
805-756-1111 • <http://www.calpoly.edu>

CALIFORNIA STATE UNIVERSITY, SAN MARCOS

333 South Twin Oaks Valley Road, San Marcos, CA 92096-0001
Dr. Karen S. Haynes, President
760-750-4000 • <http://www.csusm.edu>

SONOMA STATE UNIVERSITY

1801 East Cotati Avenue, Rohnert Park, CA 94928
Dr. Ruben Armñana, President
707-664-2880 • <http://www.sonoma.edu>

CALIFORNIA STATE UNIVERSITY, STANISLAUS

One University Circle, Turlock, CA 95382
Dr. Joseph F. Sheley, President
209-667-3122 • <http://www.csustan.edu>

